

DATE: \_\_\_\_\_ PROJECT: \_\_\_\_\_ TYPE: \_\_\_\_\_

CATALOG NUMBER LOGIC:



*\*Stainless steel rings are provided in Natural (NAT) finish regardless of finish choice.*

*\*\*Material and finish to match fixture*

*\*\*\*For use with incandescent dimmer. Driver wattage must match fixture wattage.*

**CATALOG NUMBER LOGIC**

Example: CTB - 18 - LED - x52 - BZW - A - CD1 MSH - D10INC - MT - SPG-120

**MATERIAL**

(Blank) - Aluminum C - Copper

**SERIES**

CTB - Citadel Bollard

**BASE HEIGHT (specify inches)**

14" (Standard), 18", or 22"

**SOURCE**

LED - Chip on Board Technology

**LED TYPE**

x52 - 10W LED/2700K x53 - 10W LED/3000K x54 - 10W LED/4000K

**FINISH (See page 2 for full-color swatches)**

Standard Finishes (BZP, BZW, BLP, BLW, WHP, WHW, SAP, VER)

Premium Finish (ABP, AMG, AQW, BCM, BGE, BPP, CAP, CMG, CRM, HUG, NBP, OCP, RMG, SDS, SMG, TXF, WCP, WIR)

Also available in RAL Finishes

Copper Finishes (NAT, BP, GP)

**RINGS**

A - Aluminum

B- Brass

S - Stainless Steel\*

**CAP STYLE**

CC1 - Cone Cap\*\*

CD1 - Dome Cap\*\*

CF1 - Flat Cap\*\*

**ACCESSORIES**

HS - House Side Shield\*\*

MSH - Mesh Screen\*\*

**DRIVER TYPE\*\*\***

D10INC - 10W Dimming Driver

**INPUT VOLTAGE**

MT - 120-277 Multi Tap

**OPTIONS**

CLR - Clear Coat Protection (Available on NAT finish only)

SGP-120 - 120V Surge Protection

SGP-277 - 277V Surge Protection

DATE:

PROJECT:

TYPE:

(Shown with Cone Cap - **CC1** Style)

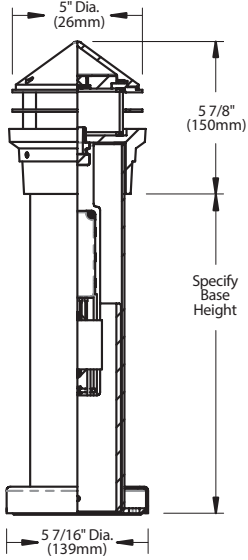

(Shown with Dome Cap - **CD1** Style)

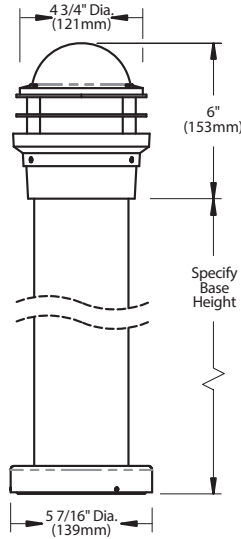

(Shown with Flat Cap - **CF1** Style and Mesh Screen - **MSH**)

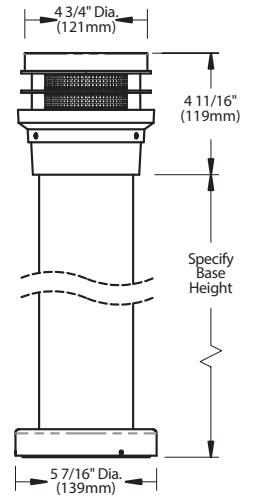

**MOUNTING PLATE**

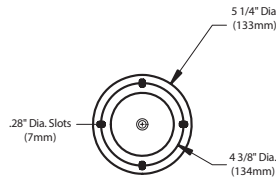

**STANDARD FINISHES**



**PREMIUM FINISHES**

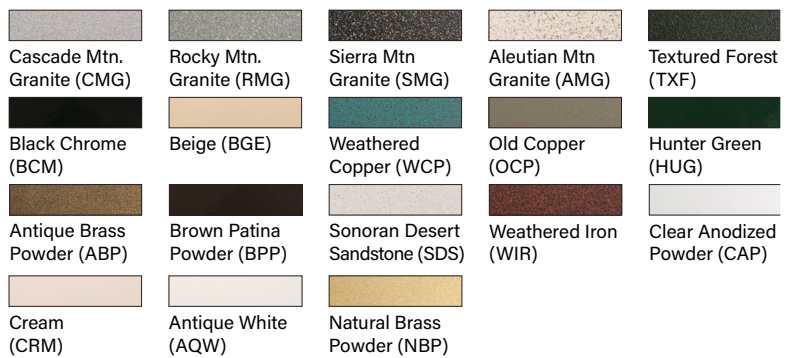

[Click Here](#) to view larger, full-color swatches of all available finishes on our website.

DATE:	PROJECT:	TYPE:
-------	----------	-------

ACCESSORIES (Configure separately)

## SPECIFICATIONS

ELECTRICAL	WATTAGE	10W LED
	LED	Integrated LED system with 'X' technology is scalable for field upgrade. Modular design with electrical quick disconnects permit field maintenance. Minimum 50,000 hour rated life at 70% of initial lumens (L70). LED technology provides long life, significant energy reduction and exceptional thermal management.
	COLOR MANAGEMENT	Chip on board technology delivers natural white light. Exact color point conformity exceeds ANSI C78.377 standard. Module exceeds 80 CRI (RA>80, R9.16). Color point uniformity 2 SDCM color control for 2700K-4000K CCT.
	WIRING DRIVER	Tefzel coated stranded wire, 18GA, 600V, 150°C rated. Integral 350mA, Class A, constant current driver. 120- 277VAC (nominal) primary input voltage. 50/60Hz. >0.90 Power Factor, <30mA in-rush current, 0.20A input current, ≤15%THD (nominal at 120VAC full load). Output overvoltage, over-current, and short circuit protection with auto recovery. EMC: FCC Title 47 Part 15 Class A compliant. Driver wattage must match Fixture wattage. *120V for dimming.
PHYSICAL	MATERIALS	Copper: Constructed from copper and brass. These enduring metals are inherently corrosion resistant. Aluminum: Constructed from Copper-free Aluminum (Type 6061-T6).
	BASE	Casted base made from 360 Aluminum or C836 Red Brass.
	INSTALLATION	5 1/4" diameter aluminum base with 304 stainless steel plate. Mounts to #34 anchor kit (included).
	HOUSING	Heavy wall 3-5/8" O.D. 6061-T6 Aluminum Tube or Type L Copper Tube.
	RINGS	Solid Accent Rings with solid spacers made from 6061-T6 Aluminum or 360 Brass.
	CAP	Top cap available in Cone, Dome or Flat style. Cone and Dome cap styles made from 360 Aluminum or C836 red Brass. Flat style cap is made from 6061-T6 Aluminum or 360 Brass.
	HOUSE SIDE SHIELD	Eliminates light from half of the fixture. Hand Spun Aluminum- 3003 or Copper- C101.
	MESH SCREEN	Diffuses light in window. Not available with House Side Shield.
	LENS	3.5"dia. translucent acrylic lens provides sealed optical compartment.
	SURGE PROTECTOR	Thermal protected Surge Protective Device. Prevents failure from sustaining over voltage conditions. Specify 120V or 277V.
	HARDWARE	Tamper-resistant, stainless steel w/ black oxide finish.
	FINISH	Copper and Brass: Natural (NAT): Copper and Brass components are sand blasted to expose the porous metal surface. Over time, and with exposure to the elements, the metals will naturally 'weather' resulting in a unique patina. Also available with hand-crafted metal finishes including brown patina (BP), green patina (GP), and polish (POL). Copper and Brass components are also available in powder coat finishes. Optional ceramic clear coat protection (Copper and Brass components only) seals and protects underlying metals and protects against discoloration, fading, and wear. Highly impervious to chemicals, solvents, and graffiti. For use with natural (NAT) finish.
	WARRANTY	Aluminum: StarGuard®, our exclusive RoHs compliant, 15 stage chromate-free process cleans and conversion coats Aluminum components prior to application of Class 'A' TGIC polyester powder coating. 5 year limited warranty.



DATE:

PROJECT:

TYPE:

### SPECIFICATIONS

PHYSICAL

LISTINGS

UL tested to IESNA LM-79. UL Listed. Certified to CAN/CSA/ANSI Standards. RoHs compliant. Suitable for indoor or outdoor use. Suitable for use in wet locations. Additionally suitable for installation within 4' of the ground. IP66 Rated. Made in USA.



# LAMP & DRIVER DATA

DATE: \_\_\_\_\_ PROJECT: \_\_\_\_\_ TYPE: \_\_\_\_\_

## DRIVER DATA

Type	AC Input Range	Frequency Hz	Power Factor at Full Load (Efficiency)	THD	InRush Current	Operating Current	Operation Ambient Temperature	Dimmer Type	Dimmer Range
D10	120-277VAC	50/60	>.90	≤15%	<30mA	350mA	20°C - 50°C	2-100%	120V dimming only. Incandescent, MLV, and ELV

### LM79 DATA

### LM70 DATA

TEKA LED #	LUMENS (Delivered)	CCT	INPUT WATTS (Typ.)	CRI (Typ.)	Minimum Rated Life (hrs.) - 70% of initial lumens (L70)
x52	452	2700	10	80	50,000
<b>x53</b>	<b>480</b>	<b>3000</b>	<b>10</b>	<b>80</b>	<b>50,000</b>
x54	495	4000	10	80	50,000

# CITADEL BOLLARD (CTB) - HORIZONTAL FOOTCANDLES

DATE:

PROJECT:

TYPE:

## CTB - LED - x54 (10W) - 4000K

Mounting Height = 3 Ft

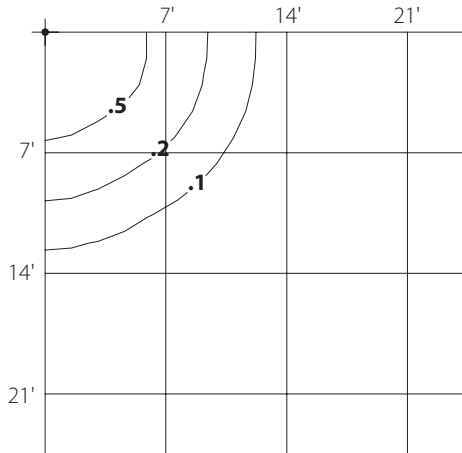

### HORIZONTAL FOOTCANDLES

Light Loss Factor = 1.00

Luminaire Lumens = 495

Maximum Calculated Value = 0.74 Fc

2.7K Multiplier = .91

3K Multiplier = .97

BUG Rating = B0 U3 G1

## CTB - LED - x54 (10W) - 4000K

Mounting Height = 3 Ft

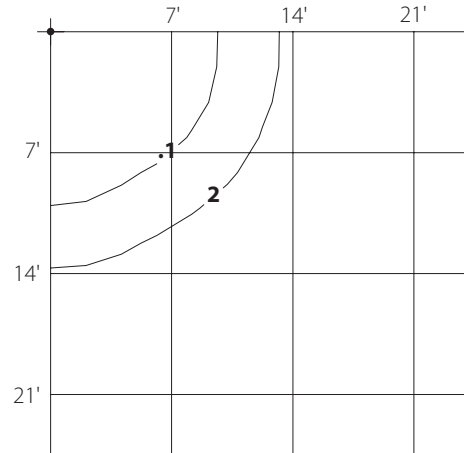

### HORIZONTAL FOOTCANDLES

Light Loss Factor = 1.00

Luminaire Lumens = 495

Maximum Calculated Value = 0.42 Fc

2.7K Multiplier = .91

3K Multiplier = .97

BUG Rating = B0 U3 G1